

Coupling designed for joining sheets with a total thickness of 4 to 5 mm.

Pressure adjustment by means of a threaded clip.

*T - Total thickness of mounting plates.

CATALOGUE NO.	COMPONENTS	MATERIAL	FINISH [C]
4.560.001	Clamp, Sleeve	ZAMAK 5	Zinc-plated steel
	Catch, Threaded sleeve	Steel	Zinc-plated steel
	Washer	EPDM	-
	Spring	Stainless steel	-

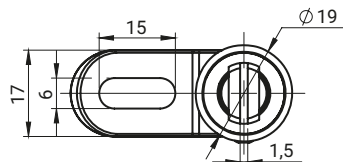
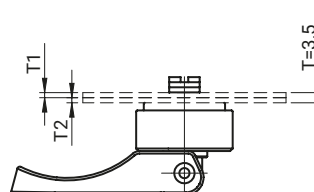
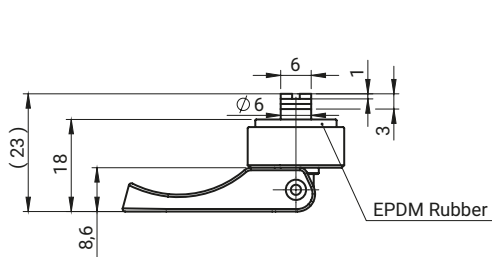

Coupling designed for joining sheets with a total thickness 3,5 mm.

Pressure adjustment by means of a threaded clip.

*T - Total thickness of mounting plates.

CATALOGUE NO.	COMPONENTS	MATERIAL	FINISH [C]
4.560.002	Clamp, Sleeve	ZAMAK 5	Zinc-plated steel
	Catch, Threaded sleeve	Steel	Zinc-plated steel
	Washer	EPDM	-
	Spring	Stainless steel	-