

INSERTS [X]				
T9	KW8	S	N	RAILWAY

TYPE OF LOCK	COMPONENTS	MATERIAL
M22SD40	Housing, insert	Stainless steel
	Cam	

**How to order:**

Type of lock

Type of insert

Height cam H = 18, 20, 22

Lock version (P-Right, L-Left)

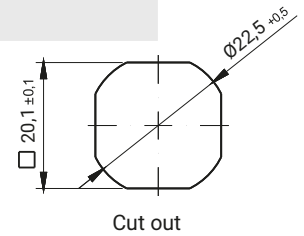
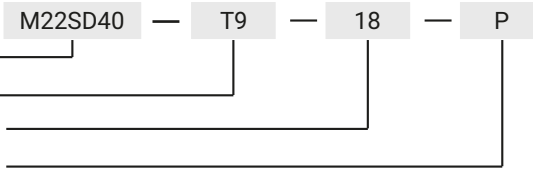

\* possibility to make in another dimension

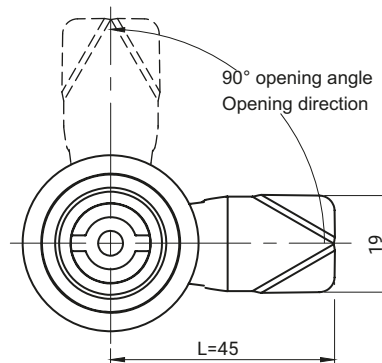
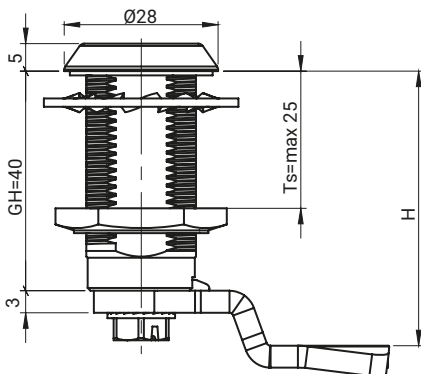

Vibration-resistant lock with protection against accidental opening.

To open / close the lock, the insert must be pressed in and then turned 90°.

TYPE OF LOCK	COMPONENTS	MATERIAL
M22SP40	Housing, Insert	Steel
	Cam	Steel zinc plated

INSERTS [X]				FINISH [C]			
				Chrome	Nickel	RAL9005	RAL7035
D3	D5	T8	KW8	01	02	04	05

**How to order:**

Type of lock

Type of insert [X]

The height of cam H

Finish [C]

where:

H - the cam unbending dimension

G - cam group

Ts - Thickness door

The lock is fitted with cams from the group: 12, 14, 17, 17A, 18, 32, 34, JK1-16018, JK2-16018, J-6000.03, J-6000.04,

JK-1610.01, JZ-002 (pg. 1C-10 to 1C-23)

\* possibility to make in another dimension

www.roztocze.eu

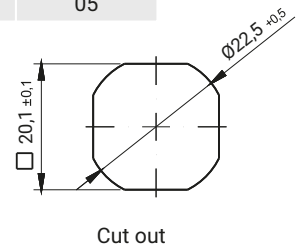
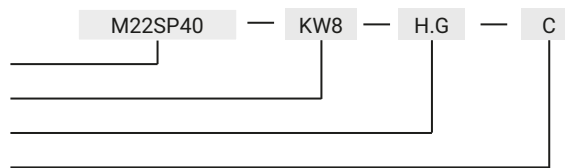

Cut out