

Cut out



TYPE OF LOCK	RS761.N	Version for a cap
	RS761.M	Version for a cogwheel mechanism

COMPONENTS	MATERIAL	FINISH [C]	
		RAL9005	RAL7035
Housing	Polyamide PA6 GF30	07	08
Handle			
Sliding dust cover			

How to order:

Type of lock

Finish

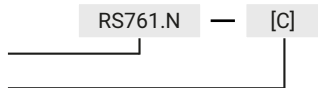

All components to order separately for version under a cap and a cogwheel mechanism are shown in charts, check pg. 1B-28.  
Patented insert to order separately, check pg 1C-1 to 1C-2.

## Swinghandle version for a cap

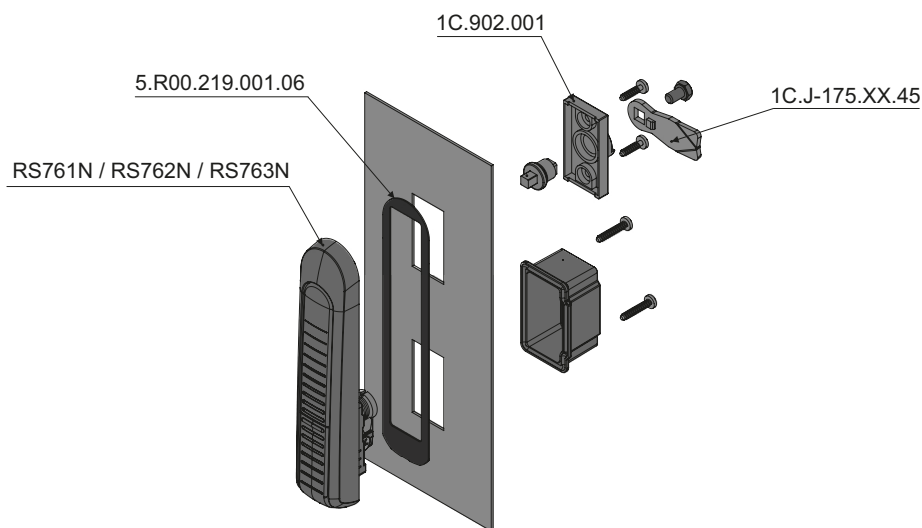

## COMPONENTS ORDERED SEPARATELY

TYPE OF LOCK	DETAIL	PAGE
RS761.N RS762.N RS763.N	Cap 1C.902.001 / 1C.902.003	1C-27
	1-point cam, group: 11, 13	1C-10, 1C-11
	2-point cam, group: 21	1C-15
	3-point cam, group: 31, 33	1C-17, 1C-18
	Rods	1C-4, 1C-5
	Rod guide	1C-6, 7
	Gasket IP65 5.R.00.219.001.06	-

## Locks for the gear mechanism

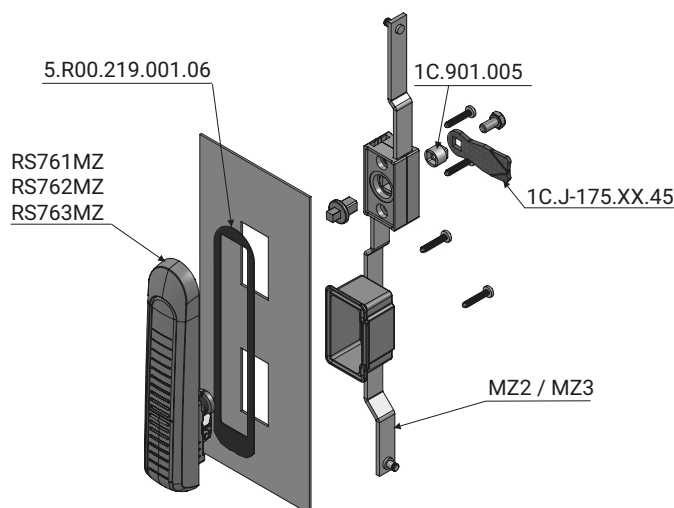

## COMPONENTS ORDERED SEPARATELY

TYPE OF LOCK	DETAIL	PAGE
RS761.M RS762.M RS763.M	Cogwheel mechanism MZ2 / MZ3	1C-30 - 1C-33
	1-point cam, group: 11, 13	1C-10, 1C-11
	Bushing 1C.901.005	1C-27
	Flat rod	1C-34 - 1C-40
	Flat rod guide and brackets	1C-6-8, 1C-34 - 1C-40
	Gasket IP65 5.R.00.219.001.06	-

Standard lock has a class of IP54.

In case of using an additional gasket number 5.R00.219.001.06 (to be ordered separately), the lock has a class of IP65.