

**ZWM8** (with thread M8)      **ZWM10** (with thread M10)

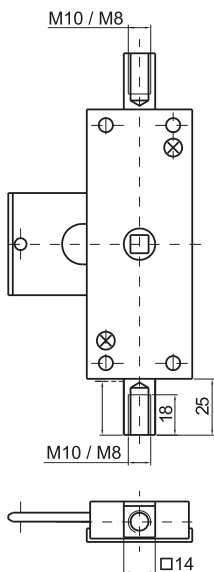

- NOTE:**
1. When ordering swinghandles RS100, RS130, RS140, RS110, RS210, RS200 for **internal lock** you should add letters ZW.
  2. When ordering swinghandle RS100, RS200, RS130, RS140, RS110, RS210, for **intednal lock panik**, you should add letters ZWP.
  3. Lock support only on special request.
  4. Left or Right version only for **internal lock panik**

**ZWM8** (with hole ø8)

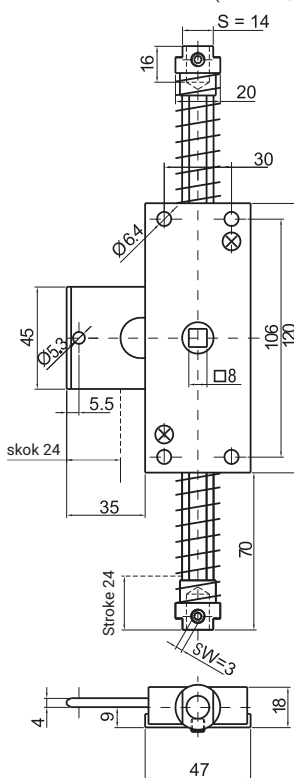

**ZWM10** (with hole ø10)

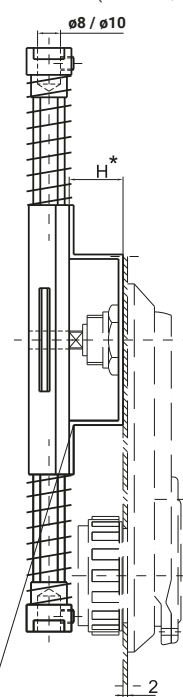

Lock support

**ZWPM8** (with thread M8)      **ZWPM10** (with thread M10)

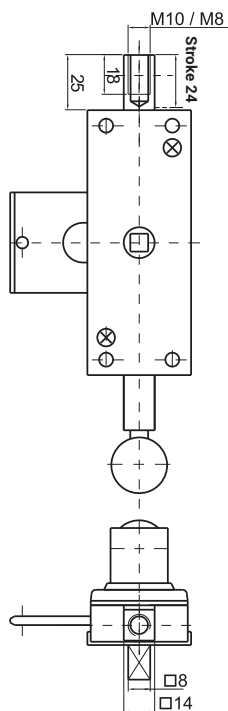

**ZWPM8** (with hole ø8)

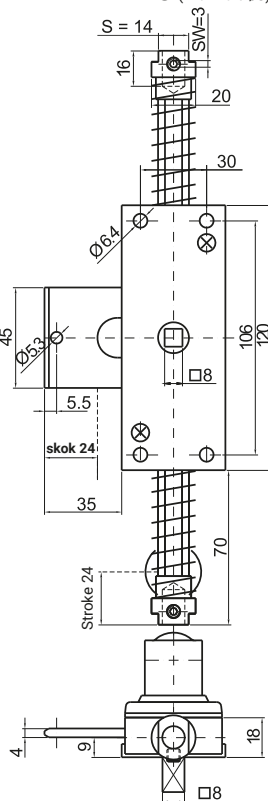

**ZWPM10** (with hole ø10)

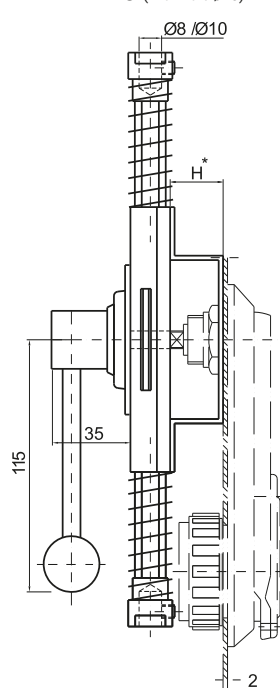

- NOTE:**
1. When ordering lock ZWP you must define H dimension and version: left or right

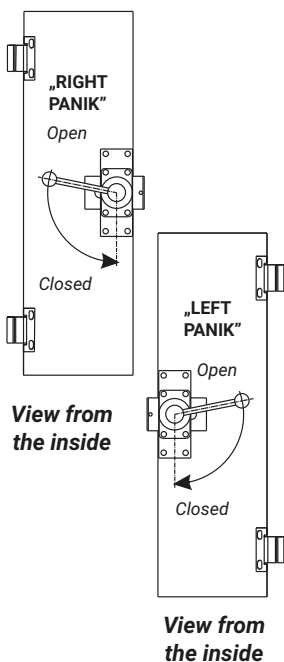

NAME	MATERIAL	NAME	MATERIAL
Internal lock ZWM8	Steel zinc plated	Internal lock panik ZWPM8	Steel zinc plated
Internal lock ZWM10		Internal lock ZWPM10	
Internal lock ZW8		Internal lock ZWP8	
Internal lock Zw10		Internal lock ZWP10	

• When ordering you must define H dimension