

External viewfinder     $T_s$     Viewfinder internal  
 $T_{smin} - T_{smax}$

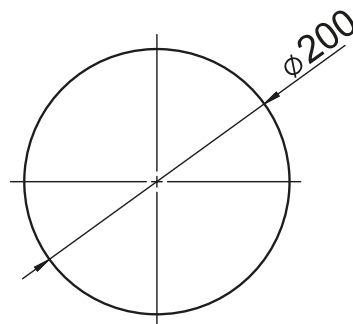

cut out

CATALOGUE NO.	DIMENSION $T_s$	DETAL	COMPONENTS	MATERIAL
4.425.001	19 - 35	Inspection window	Viewfinder	Polycarbonate
4.425.002	39 - 53		Gasket	EPDM
4.425.003	54 - 65			
4.425.004	70 - 90			
4.425.005	95 - 110			

$T_{smin} - T_{smax}$  - the range of thickness adjustment of inspection window